

RoHS COMPLIANT

REV	DATE	DESCRIPTION
E	11/10/'14	Correct DIM

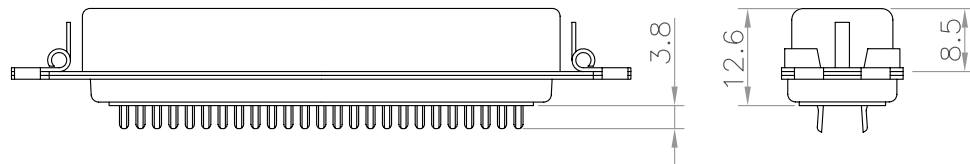

Positions	A	B	C	D
14	12.96	25.2	36.0	44.1
24	23.76	36.0	46.8	55.0
36	36.72	48.9	59.7	68.0
50	51.84	64.1	74.9	83.0

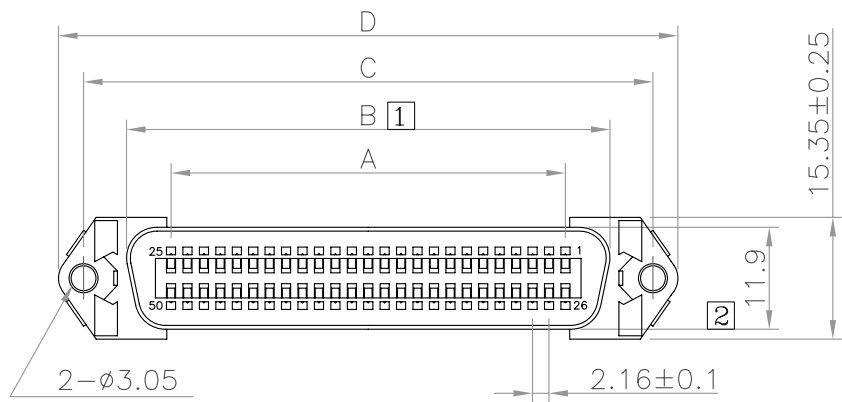
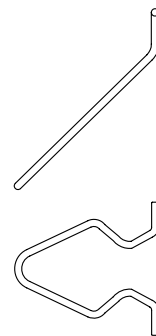

### Material & Finish

**SHELL:**

Steel  
Zinc plated, Tin plated  
or Nickel plated steel

**PIN CONTACT:**

Phosphor bronze or Brass  
Gold plated

**INSULATOR:**

PBT & Glass-fibre reinforced  
UL-94-V0

**NUMBER OF CONTACT:**

14,24,36,50

**CURRENT RATING:**

5 Amp

**DIELECTRIC STRENGTH:**

1000V for one minute

**INSULATOR RESISTANCE:**

1000MΩ Min. (at 500V DC)

**TEMPERATURE:**

-55°C to +105°C



FU-YAO TECHNOLOGY CO., LTD.  
復堯科技股份有限公司

MODEL NAME:  
CENTRONIC SOLDER TYPE FEMALE  
APPOSE SPRING LATCH

MARK EXPLAIN:  
 ▲:Revision Change  
 ①:Important Dimension  
 ①:Note  
 TOLERANCE:  
 0.000:  
 0.00 : ±0.20  
 0.0 : ±0.30  
 0. : ±0.40  
 ANGLE: ±3.0°  
 UNIT: mm

PART NO. RC4-xxSXXXA02000  
 APPROVED BY:  
 CHECKED BY:  
 DRAW BY: Jarvis  
 FILE NO. FIG00082  
 SCALE: FREE  
 DATE : 880806