

Poles	DIM.A	DIM.B
2x2	2.0	5.9
2x3	4.0	7.9
2x4	6.0	9.9
2x5	8.0	11.9
2x6	10.0	13.9
2x7	12.0	15.9
2x8	14.0	17.9
2x9	16.0	19.9
2x10	18.0	21.9
2x11	20.0	23.9
2x12	22.0	25.9
2x13	24.0	27.9
2x14	26.0	29.9
2x15	28.0	31.9
2x16	30.0	33.9
2x17	32.0	35.9
2x18	34.0	37.9
2x19	36.0	39.9
2x20	38.0	41.9

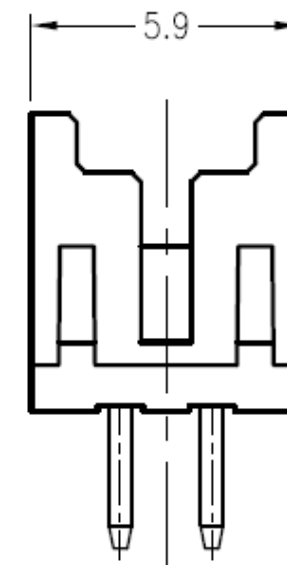
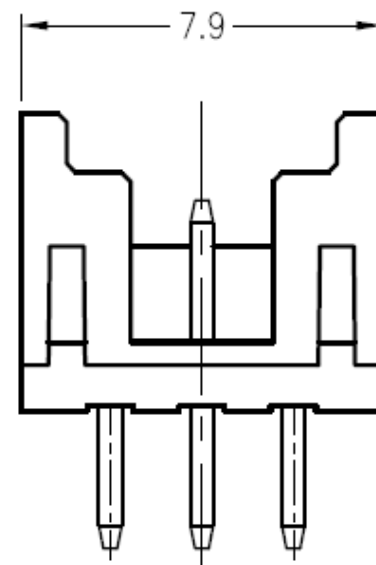
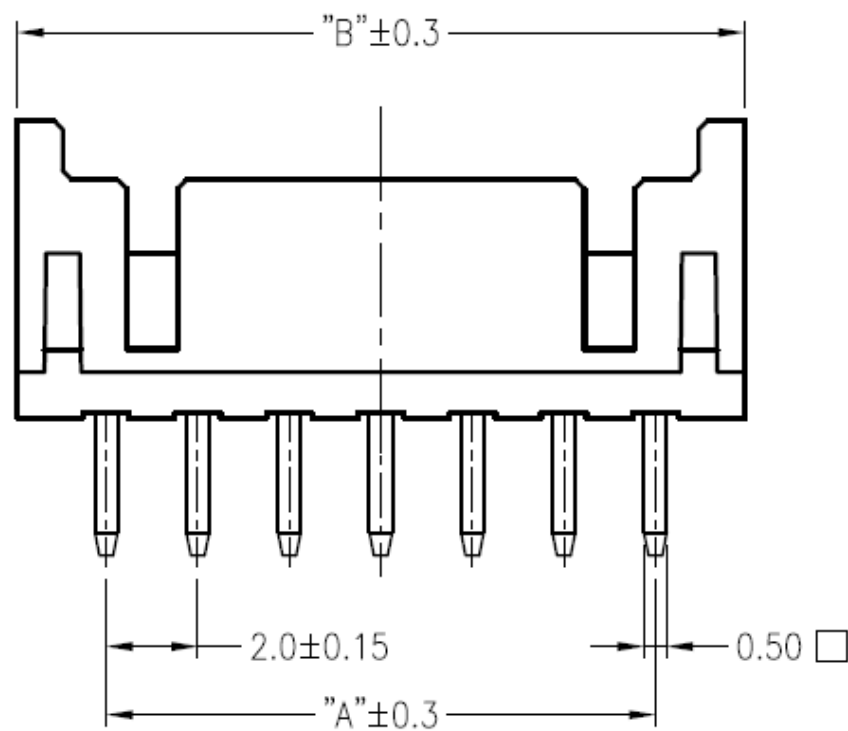
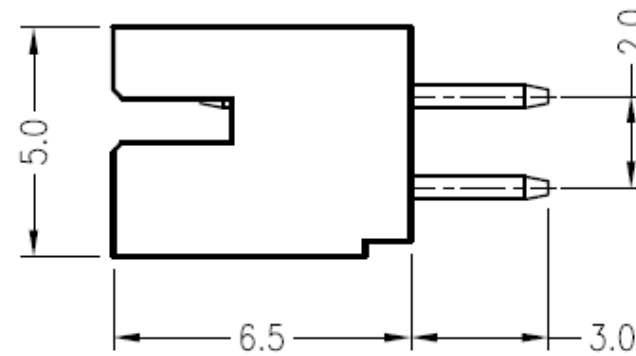
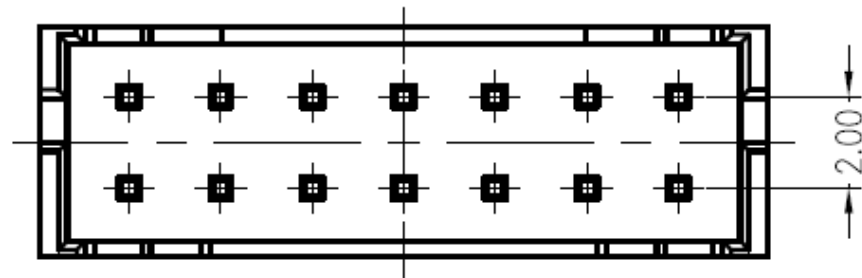

SPECIFICATIONS:
 Applicable Wire: AWG#22~#28
 Voltage Rating: 250V AC/DC(rms)
 Current Rating: 3A
 Withstand voltage: 800V AC/Min(rms)
 Operating Temperature: -25°C~+85°C
 Insulation Resistance: 1000MΩ min.
 Contact Resistance: 30mΩ max.
MATERIAL:
 Terminal: Brass
 Housing: PA46,UL94V-0

RoHS
Compliant

2x4P~2x20P

2x3P

2x2P

Ordering Information

WG - 2 - XX - PT - 2PHD-1-44

2.0Ph Wafer Solder/PCB Total Pin Contact Plated Packaging
 2:DIP VT PT: Tin 1: Bag

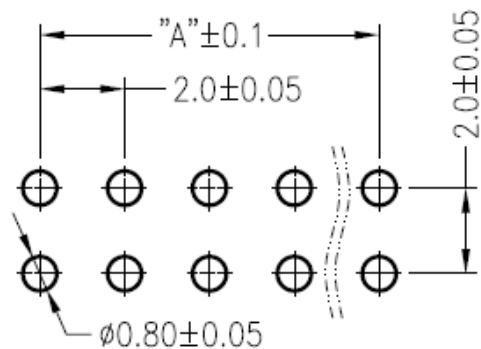

RECOMMENDED PCB LAYOUT

REV.	REVISION RECORD	DATE	General Tolerance
A	Original	02/14/22	LINEAR 0.0 ±0.25 ANGLE ±3° 0.00 ±0.20
			UNIT: mm
			A4 NAME
			APPROVED KENNY
			CHECKED GRACE
			DESIGNER JNDAR

ARIBA
TECHNOLOGY CO., LTD.

TITLE: 2.0Ph Wafer DIP Vertical Dual Rows 6.5H

DWG.NO: **WG2XXPT2PHD1-44** REV. A

SCALE 1 : 1 SHEET 1 OF 1